The background of the cover is a collage of architectural images. The top left shows a close-up of a modern building's curved, metallic roof structure. The bottom half features a wide-angle, dusk-time photograph of a large, modern architectural complex with multiple interconnected buildings, some with curved roofs, surrounded by landscaped grounds with palm trees and a parking area. The entire composition is overlaid with large, abstract geometric shapes in various shades of blue and grey, creating a dynamic, layered effect.

ARCHITECTURAL SHEET METAL ROOF & CLADDING

SYSTEM & DESIGN

LOCKWELTFORM STANDING SEAM

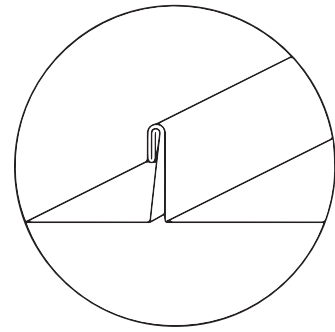

Introduction

Lockweltform Standing Seam is a premium architectural roofing system which and can be customized to suit special roof shapes and geometry.

The detailing and installation of this system require technical knowledge and skilled craftsmanship. Special hand tools are used on-site to handcraft each element to achieve a masterpiece-roof.

Various materials can be used to complement the roof design, be it Aluminium, Copper, Titanium, or Stainless Steel.



Transformer Manufacturing Facility (MTM), Kapar



Fakulti Pergigian Auditorium Uitm

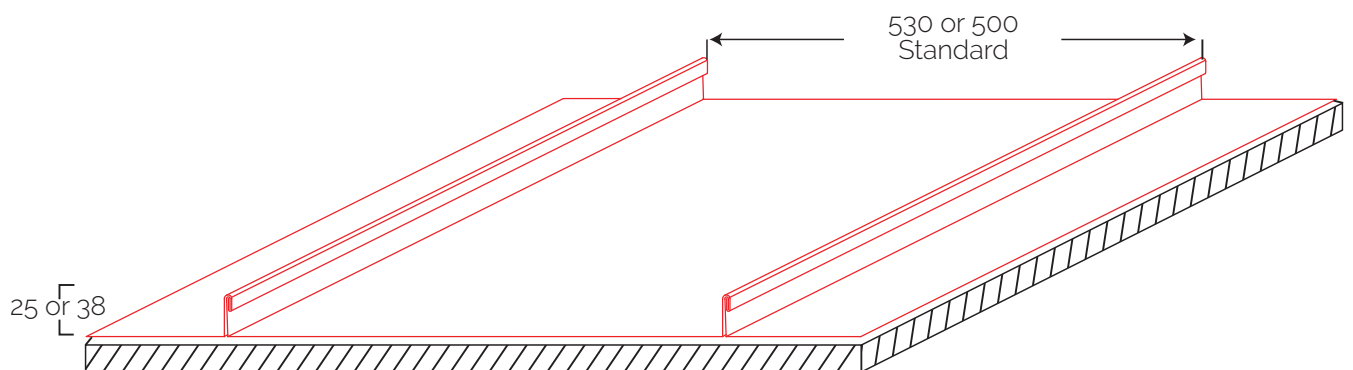

Weatherproof even on Low-pitch Roof

With a tightly sealed and double-locked seam, Lockweltform Standing Seam caters to an extremely low pitch roof. It is recommended to have a minimum roof pitch of 3°, but a roof pitch of 1° to 2° is still achievable with a special treatment at the seam to prevent water ingress.

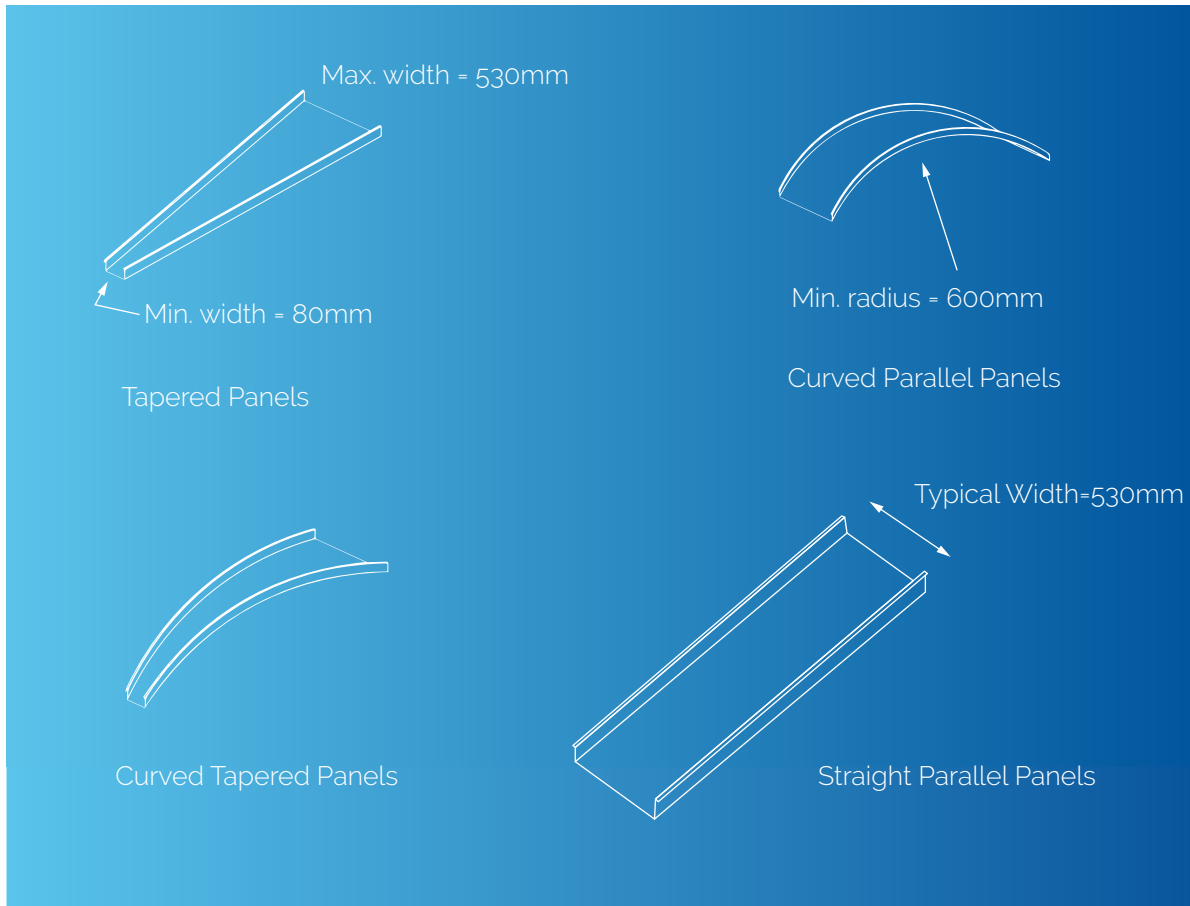

Mersing Harbour Center



Stadium Bola Sepak, Kuala Lumpur

Concealed Fixing which accommodates Thermal Expansion and Contraction

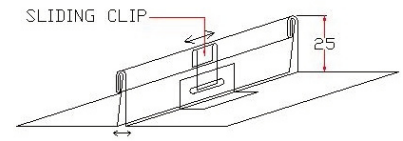

Concealed Sliding Clips
accommodates lateral and
longitudinal movements

Conventional metal roofs have exposed fasteners puncturing through the roof sheet, making it susceptible to leak.

Lockweltform Standing Seam system incorporates concealed fixing techniques, whereby there is no visible screw on the roof. This will enhance the aesthetic view of the roof and eliminate any possibility of leakage. The reasoning is simple, no puncture through the roof, no water seepage.

Metal will expand and contract in response to temperature change. If it is not addressed properly, it will cause detrimental thermal stress and pre-mature wear over time.

Lockweltform Standing Seam system uses special stainless steel fixed and sliding clips to secure the roof sheets while allowing the roof sheets to move freely by sliding over the clips in response to the daily temperature change.

Making the Roof Stand Out

The edging-detail of the roof makes a statement to the design. Lockweltform Standing Seam roof eave is neatly closed all-round (as oppose to convention roofs having open corrugation edges). Various perimeter treatment is possible with this system. ALCOM Dach&Wand works together to create and perpetuate the concept chosen.

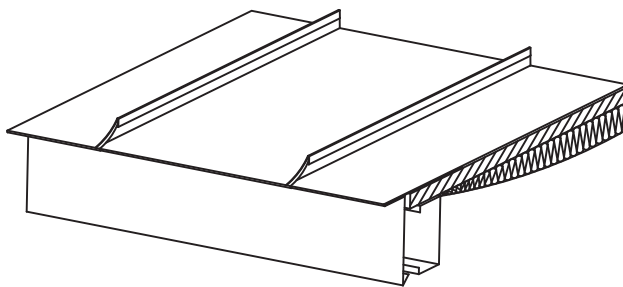

Roof Eave Profile

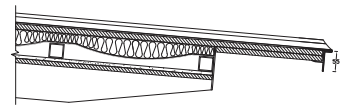

Slim roof edge design

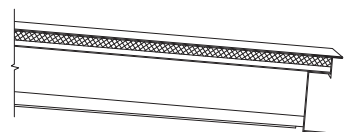

C-profile design

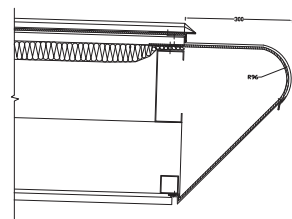

Bullnose design

Acoustic and Thermal Control Roof System

A good roof system dampens external heat and sound, soothes the occupants within.

ALCOM Dach&Wand Lockweltform Standing Seam can be designed to achieve the Thermal Transmittance Value (U-Value) and Sound Transmission Class (STC Value) requirements of the building.

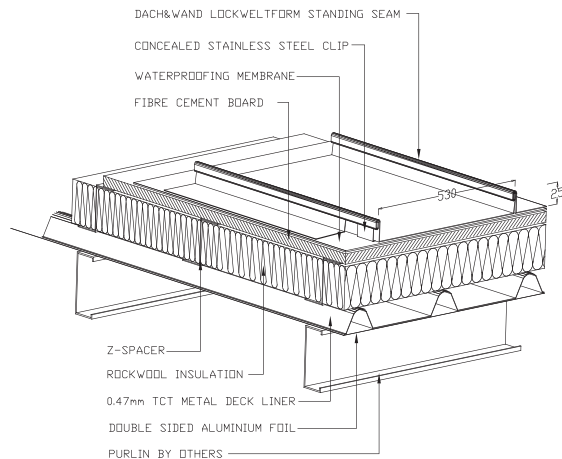

STC 45 Build up System



SPRM Auditorium, Putrajaya.

Multiple Pitch on a Single Roof

Where conventional metal deck shy away from this design, Lockweltform Standing Seam aggressively thrives this challenge while ensuring water-tightness and longevity.

This will ultimately push the boundaries of architects to create glorious masterpieces.



Augusta Precinct 12, Putrajaya



Garden Manor Sierramas, Sg. Buloh

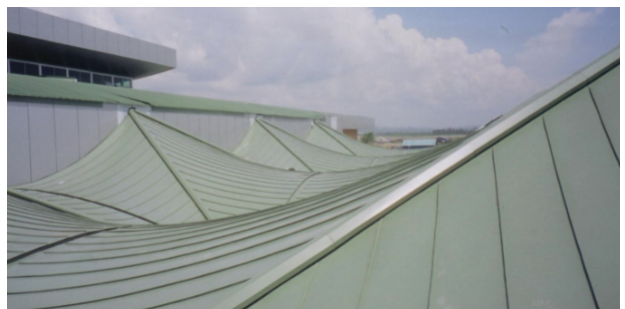

Miri International Airport, Sarawak

SHADOWFORM ANGLE SEAM

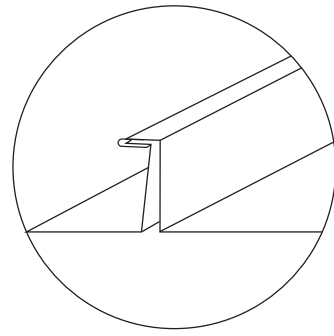

MRT Pasar Seni, Kuala Lumpur

Introduction

For architects who prefer more prominent-looking seam lines and linear texture on the roof, the Shadowform Angle Seam profile is the solution.

The system is adopted from the Lockweltform Standing Seam profile. It is produced by singly folding the seam to a 90-degree turn instead of folding it twice to form Lockweltform.

When sunlight is cast onto Shadowform, the 'shadow' effect gives thicker solid lines to the roof. This system is frequently used on the fascia, façade cladding, soffit, or ceiling.

Characteristics

Since Shadowform Angle Seam System is the adoption of Lockweltform, both systems share the same characteristics; concealed fixing, water-tightness, thermal expansion and contraction accommodation, and an array of material choices.

The only significant difference of Shadowform is the stronger texture it presents to the surface. From an architectural point of view, it is perfect for fascia, soffit ceiling, wall, or façade cladding



Private Bungalow, Kota Damansara



Private Bungalow, Ukay Heights

Integrated System between roof and cladding

Since Shadowform has the same dimensional properties as the Lockweltform, it can be incorporated as a total integrated roofing system, Lockweltform for the roof and Shadowform for the fascia and soffit.

With this complete system design, the roof stands out as an individual entity complementing the whole building's geometry.

Lockweltform Standing Seam

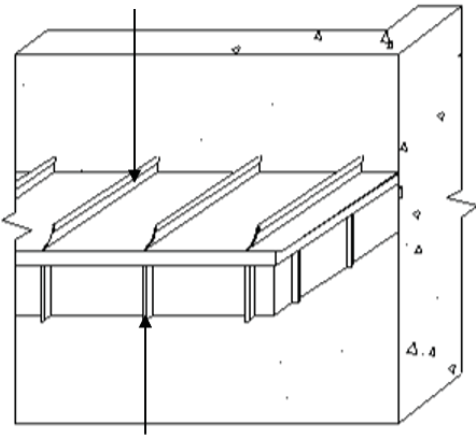

Shadowform Angle Seam



Kuala Terengganu Draw Bridge



Gravit8 Sales Gallery, Klang, Selangor.



SHINGLEFORM FLAT SEAM

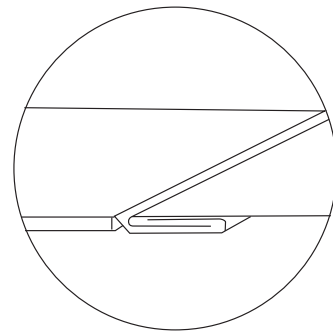

Introduction

Shingleform Flat Seam comes in various designs to meet the demanding architectural requirements. It is the most versatile tile roof available in the market. Also called 'Metal Tiles', this system enables architects to have unique patterns on the roof or wall. By incorporating different colors to the metal tiles, this profile turns creativity into reality. The roof or wall is no longer just a shelter for the building, it also acts as an art-piece that enhances the overall aesthetics of the building.

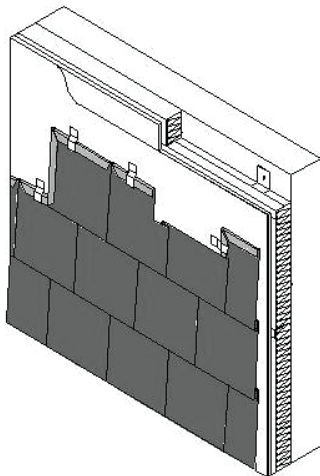

Brick-lay
Design



Rawang Commercial Center

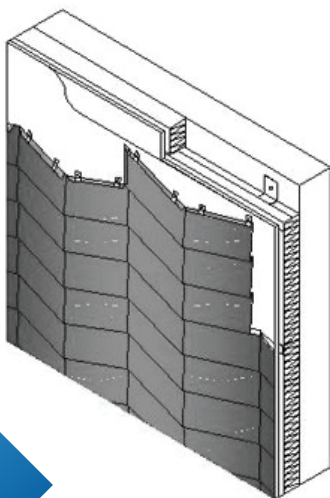

Herringbone
Design



SACC Mall, Shah Alam

Characteristic

Shingleform Flat Seam is an interlocking rather than an overlapping system. The concealed interlocking system prevents rattling and loose tiles from falling. Stainless steel clips and fasteners are used to ensure durability and provide high security to the roof and wall.

This system is effective in preventing water ingress with a roof pitch of 25°. For lower pitch, an internal drainage or waterproofing system is to be designed underneath the Shingleform system.



ELS Desaru Club, Johor

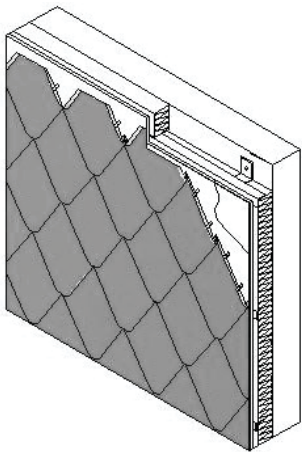

Rhomboid
Design



Malaysia High Commission Singapore

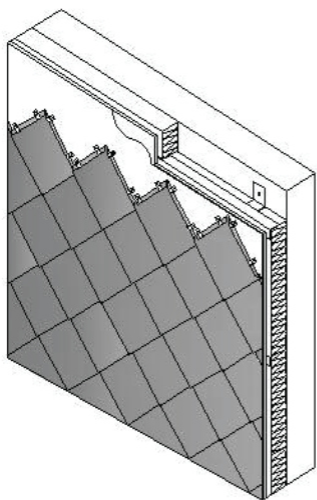

Diamond
Design



ELS Desaru Club, Johor

BATTENFORM ROLLCAP

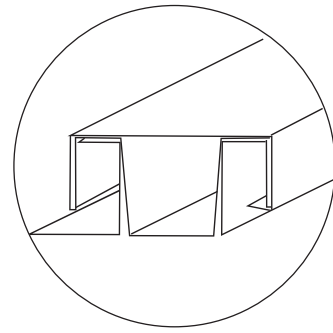

Introduction

Battenform Rollcap system provides a stronger design outlook to the roof surface than Lockweltform or Shadowform system.

With a specially crafted capping seam of widths 80mm or wider, Battenform creates a muscular and conspicuous contour to the roof thus presenting a bold and gallant appearance to the building.

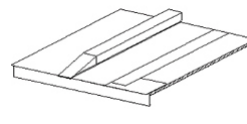
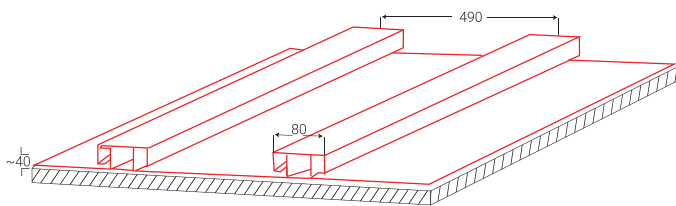

Tapered
eave ends

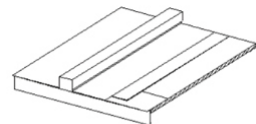

Straight
eave ends

Advantages

The height of Battenform is 40mm (typical) or higher while the capping width is 80mm (typical). The width and height of the roll-cap seam can vary according to architectural desire and preference.

Battenform Rollcap has the advantage of easy repair when the need arises. Only simple hand tools are required to install the roof sheets. The capping system prevents capillary action that may occur in extreme weather conditions.

To add to the flexibility of the system, Battenform can be used harmoniously with other profiles such as Lockweltform and Shingleform. The mixture of wide solid lines and slender sleek lines provide a very sophisticated and elegant appearance to the roof.



Unisel Mosque, Bestari Jaya

LINEARFORM CLADDING PANEL

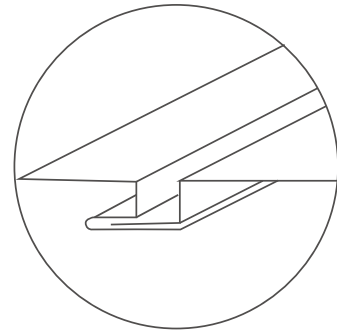

Introduction

Linearform Cladding Panel is a long-strip panel cladding that employs a tongue-and-groove concealed fixing system. It offers an alternative to the commonly used Aluminium composite panel cladding. There is no sealant required at the shadow-joint, thus eliminating the water streaking mark on the panel.

Linearform Cladding Panel is the perfect choice for renovation to rejuvenate the building façade. It provides a lightweight solution to re-clad the building with a long-lasting metal panel. Other than façade cladding, it is also suitable for fascia and soffit ceiling.



Linearform panel is used as the soffit ceiling at private bungalow in Kuala Lumpur

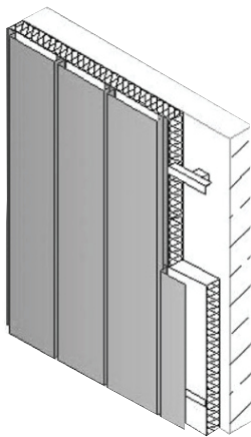

Vertical Arrangement



Private Bungalow at Sierramas Residency

Profiling and Arrangement

Linearform Cladding Panel can be fabricated in visible width of around 200mm to 400mm, and up to 6000mm in length. The groove joint is 20mm deep and the width can vary from 0mm to 25mm.

The panel is flexible in laying direction. Depending on the building design, it can be installed horizontally, vertically, or even diagonally.

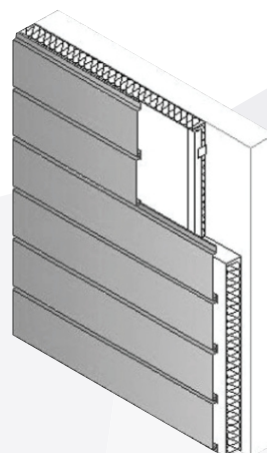

Horizontal Arrangement



alcom

Dach&Wand

YOUR ROOF & CLADDING SPECIALIST

No. 2 Pusat Perniagaan Bestari
Jalan Permata 1B/KS09,
Taman Perindustrian Air Hitam,
42000 Klang, Selangor,
Malaysia



+60331231353



+60331231311



www.alcom-dw.com